

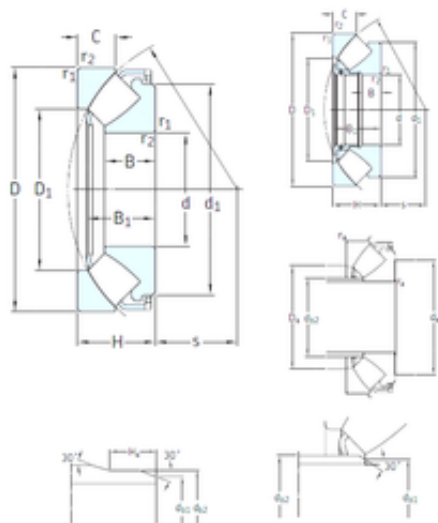

## BEARING-MALAYSIA SDN.BHD.



630 mm x 1090 mm x 181 mm SKF 294/630EM  
thrust roller bearings

Bearing No. 294/630EM

|                               |                 |
|-------------------------------|-----------------|
| Size                          | 630x1090x137 mm |
| Bore Diameter                 | 630 mm          |
| Outer Diameter                | 1090 mm         |
| Width                         | 137 mm          |
| d                             | 630 mm          |
| D                             | 1090 mm         |
| C                             | 137 mm          |
| H                             | 280 mm          |
| d1                            | 995 mm          |
| r1 min.                       | 12 mm           |
| r2 min.                       | 12 mm           |
| s                             | 365 mm          |
| B                             | 181 mm          |
| B1                            | 270 mm          |
| D1                            | 815 mm          |
| da min.                       | 860 mm          |
| Da max.                       | 950 mm          |
| ra max.                       | 10 mm           |
| Weight                        | 1040 Kg         |
| Basic dynamic load rating (C) | 14400 kN        |
| Basic static load rating (C0) | 62000 kN        |
| Fatigue load limit (Pu)       | 4150            |
| Reference speed               | 260 r/min       |
| Limiting speed                | 500 r/min       |

294/630EM Bearing 2D drawings and 3D CAD models