

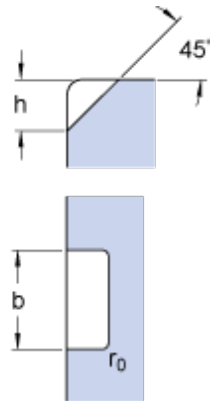

BEARING-MALAYSIA SDN.BHD.

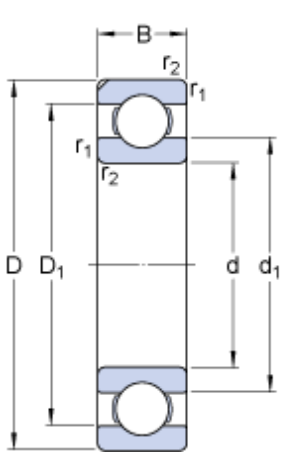

800 mm x 1150 mm x 155 mm SKF 60/800
N1MAS deep groove ball bearings

Bearing No. 60/800 N1MAS

60/800 N1MAS Bearing 2D drawings and 3D CAD models

Size	1150x800x155 mm
Bore Diameter	1150 mm
Outer Diameter	800 mm
Width	155 mm
d	800 mm
D	1150 mm
B	155 mm
d ₁	914.04 mm
D ₁	1031.4 mm
h	32 mm
b	20.5 mm
r _{1,2} - min.	7.5 mm
r ₀	3 mm
d _a - min.	828 mm
D _a - max.	1122 mm
r _a - max.	6 mm
Basic dynamic load rating - C	1010 kN
Basic static load rating - C ₀	2550 kN
Fatigue load limit - P _u	34.5 kN
Reference speed	900 r/min
Limiting speed	750 r/min
Calculation factor - k _r	0.025
Calculation factor - f ₀	16
d ₁	914.04 mm



BEARING-MALAYSIA SDN.BHD.

D_1	1031.4 mm
r_0	3 mm
$r_{1,2}$ min.	7.5 mm
d_a min.	828 mm
D_a max.	1122 mm
r_a max.	6 mm
Basic dynamic load rating C	1010 kN
Basic static load rating C_0	2550 kN
Fatigue load limit P_u	34.5 kN
Calculation factor k_r	0.025
Calculation factor f_0	16
Mass bearing	523 kg