

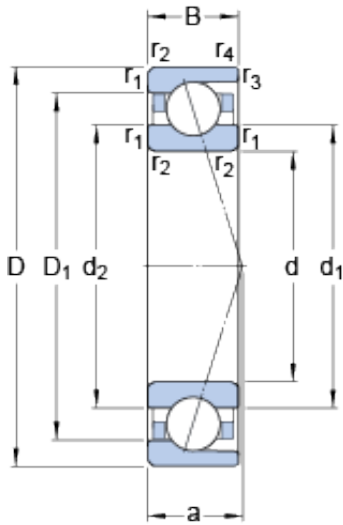

BEARING-MALAYSIA SDN.BHD.



71952 ACD/P4A Bearing 2D drawings and 3D CAD models

260 mm x 360 mm x 46 mm SKF 71952
ACD/P4A angular contact ball bearings

Bearing No. 71952 ACD/P4A

Size	360x260x46 mm
Bore Diameter	360 mm
Outer Diameter	260 mm
Width	46 mm
d	260 mm
D	360 mm
B	46 mm
d ₁	291.8 mm
d ₂	291.8 mm
D ₁	328.2 mm
r _{1,2} - min.	2.1 mm
r _{3,4} - min.	1.1 mm
a	95.5 mm
d _a - min.	271 mm
d _b - min.	271 mm
D _a - max.	349 mm
D _b - max.	354 mm
r _a - max.	2 mm
r _b - max.	1 mm
d _n	299.7 mm
Basic dynamic load rating - C	265 kN
Basic static load rating - C ₀	400 kN
Fatigue load limit - P _u	9.6 kN
Limiting speed for grease	2800 r/min



BEARING-MALAYSIA SDN.BHD.

Lubrication	
Limiting speed for oil lubrication	4300 mm/min
Ball - D_w	30.162 mm
Ball - z	29
G_{ref}	150 cm ³
Calculation factor - e	0.68
Calculation factor - Y_2	0.87
Calculation factor - Y_0	0.38
Calculation factor - X_2	0.41
Calculation factor - Y_1	0.92
Calculation factor - Y_2	1.41
Calculation factor - Y_0	0.76
Calculation factor - X_2	0.67
Preload class A - G_A	1650 N
Preload class B - G_B	3300 N
Preload class C - G_C	6600 N
Preload class D - G_D	13200 N
Calculation factor - f	1.24
Calculation factor - f_1	0.98
Calculation factor - f_{2A}	1
Calculation factor - f_{2B}	1.04
Calculation factor - f_{2C}	1.08
Calculation factor - f_{2D}	1.14
Calculation factor - f_{HC}	1
Preload class A	616 N/micron
Preload class B	807 N/micron
Preload class C	1071 N/micron
Preload class D	1455 N/micron



BEARING-MALAYSIA SDN.BHD.

Category	Precision Ball Bearings
Inventory	0.0
Manufacturer Name	SKF
Minimum Buy Quantity	N/A
Weight / Kilogram	0
Product Group	B04270
Enclosure	Open
Precision Class	ABEC 7 ISO P4
Material - Ball	Steel
Number of Bearings	1 (Single)
Contact Angle	25 Degree
Preload	None
Raceway Style	1 Rib Outer Ring
Cage Material	Phenolic
Rolling Element	Ball Bearing
Flush Ground	No
Inch - Metric	Metric
Other Features	Single Row Angular Contact High Capacity Basic Design
Long Description	260MM Bore; 360MM Outside Diameter; 46MM Width; Open Enclosure; ABEC 7 ISO P4 Precision; Steel Ball Material; 1 (Single) Bearing; 25 Degree Contact Angle; Phenolic Cage Material; 1 Rib Outer Ring Ra
Category	Precision Ball Bearings
UNSPSC	31171531
Harmonized Tariff Code	8482.10.50.28
Noun	Bearing
Keyword String	Ball Angular Contact
Manufacturer URL	http://www.skf.com



BEARING-MALAYSIA SDN.BHD.

Bore	10.236 Inch 260 Millimeter
Width	1.811 Inch 46 Millimeter
Outside Diameter	14.173 Inch 360 Millimeter
d_1	291.8 mm
d_2	291.8 mm
D_1	328.2 mm
$r_{1,2}$ min.	2.1 mm
$r_{3,4}$ min.	1.1 mm
d_a min.	271 mm
d_b min.	271 mm
D_a max.	349 mm
D_b max.	354 mm
r_a max.	2 mm
r_b max.	1 mm
d_n	299.7 mm
Basic dynamic load rating C	265 kN
Basic static load rating C_0	400 kN
Fatigue load limit P_u	9.65 kN
Attainable speed for grease lubrication	2800 r/min
Attainable speed for oil-air lubrication	4300 r/min
Ball diameter D_w	30.162 mm
Number of balls z	29
Reference grease quantity G_{ref}	150 cm ³
Preload class A G_A	1650 N
Static axial stiffness, preload class A	616 N/ μ m
Preload class B G_B	3300 N
Static axial stiffness, preload class B	807 N/ μ m
Preload class C G_C	6600 N
Static axial stiffness, preload	1071 N/ μ m



BEARING-MALAYSIA SDN.BHD.

class C	
Preload class D G_D	13200 N
Static axial stiffness, preload class D	1455 N/ μ m
Calculation factor f	1.24
Calculation factor f_1	0.98
Calculation factor f_{2A}	1
Calculation factor f_{2B}	1.04
Calculation factor f_{2C}	1.08
Calculation factor f_{2D}	1.14
Calculation factor f_{HC}	1
Calculation factor e	0.68
Calculation factor (single, tandem) Y_2	0.87
Calculation factor (single, tandem) Y_0	0.38
Calculation factor (single, tandem) X_2	0.41
Calculation factor (back-to-back, face-to-face) Y_1	0.92
Calculation factor (back-to-back, face-to-face) Y_2	1.41
Calculation factor (back-to-back, face-to-face) Y_0	0.76
Calculation factor (back-to-back, face-to-face) X_2	0.67
Mass bearing	12.2 kg